



ROME  
WEST  
REALTY

2756 LAFAYETTE ST. LOUIS MO 63104

314-833-5551

2027-2029-2031-2033-2035 Delmar Blvd., St. Louis, MO 63106  
1,908 - 3,751 Sq. Ft. Office, Retail



- ❖ 3' high (pickup truck height, or city loading dock height) gate from the parking lot to the patio,
- ❖ Each entrance has a double-door opening 4' 8" wide x 8' high
- ❖ White box finishes
- ❖ 15+ car parking adjacent to the building
- ❖ 2027 Delmar – 1908sf
- ❖ 2029 Delmar – 1843sf
- ❖ 2031 Delmar – 1795sf (LEASED)
- ❖ 2033 Delmar – 1743sf (PENDING)
- ❖ 2035 Delmar – 2113sf (PENDING)

FOR LEASE:

2027 Delmar Blvd - \$9 per sq. ft. NNN

2029-2035 Delmar Blvd - \$8 per sq. ft. NNN

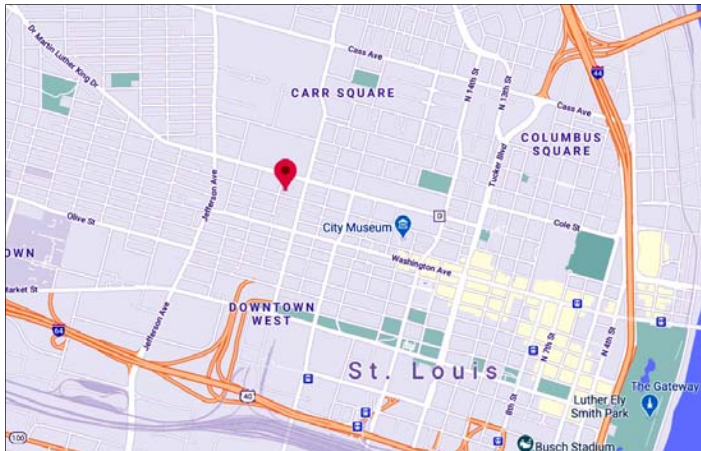

Rome West Realty LLC is the listing broker of this property and therefore represents the owner.

Missouri Broker Disclosure Form

Rome West Realty LLC does not represent the buyer or tenant when showing this property or providing information, unless otherwise agreed to in writing.

CONTACT Susan Sauer 314-660-0222 susan.sauer@romewestrealtyllc.com

www.RomeWestRealtyLLC.com



ROME  
WEST  
REALTY

2756 LAFAYETTE ST. LOUIS MO 63104

314-833-5551

2027-2029-2031-2033-2035 Delmar Blvd., St. Louis, MO 63106

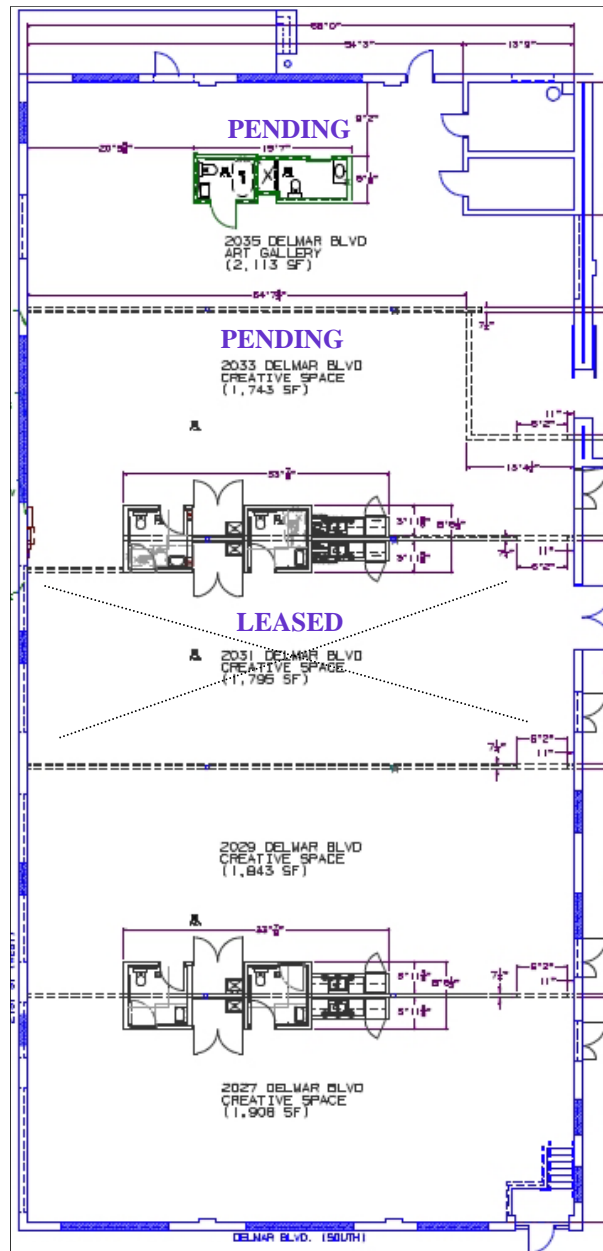

Rome West Realty LLC is the listing broker of this property and therefore represents the owner.

Missouri Broker Disclosure Form

Rome West Realty LLC does not represent the buyer or tenant when showing this property or providing information, unless otherwise agreed to in writing.

CONTACT Susan Sauer 314-660-0222 susan.sauer@romewestrealtyllc.com

www.RomeWestRealtyLLC.com